

THE HILL

SAN JOSE, CALIFORNIA

"The Hill" creates an iconic space in San Jose. It does this by taking advantage of the geography and weather of the area, utilizing socially engaging programming, and a formal design language driven by technology.

Formal Design Language
 Artificial Intelligence (A.I.) has the potential to change the way the world looks and operates. The pioneers on the forefront of this technology are in Silicon Valley. It is proposed that the design language of "The Hill" should be driven by an A.I. Machine Learning Process known as generative design. Generative design is a design exploration process. Designers & engineers input design goals into the generative design software, along with parameters such as performance or spatial requirements, materials, manufacturing methods, and cost constraints. The software explores all the possible permutations of a solution, quickly generating design alternatives. It tests and learns from each iteration what works and what doesn't. Generative design lets you create optimized complex shapes and internal lattices. Some of these forms are impossible to make with traditional manufacturing methods. Instead, they're built using new additive manufacturing methods (3D printing).

Cultural Hub
 The vegetated side of "The Hill" will act as an amphitheater, helping to bring live music, performance, and film to a public venue in downtown San Jose. The underside of the Hill will serve as a Farmers Market. San Jose is within close proximity to one of the world's great agricultural regions. By creating a covered central market "The Hill" helps draw attention to and celebrate local produce and the unique culture of the surrounding area. Throughout history food and markets have been great places for the exchange of culture and new ideas. The market component of "The Hill" will ensure it is a hub of activity and alive with the sounds and smells of many cultures.

Weather and Geography
 The bay area is famous for its fog known as the marine layer. The tower portion of the project would utilize fog water harvesting mesh to collect water for nourishment of a garden of native plants, creating an OASIS in the middle of San Jose.

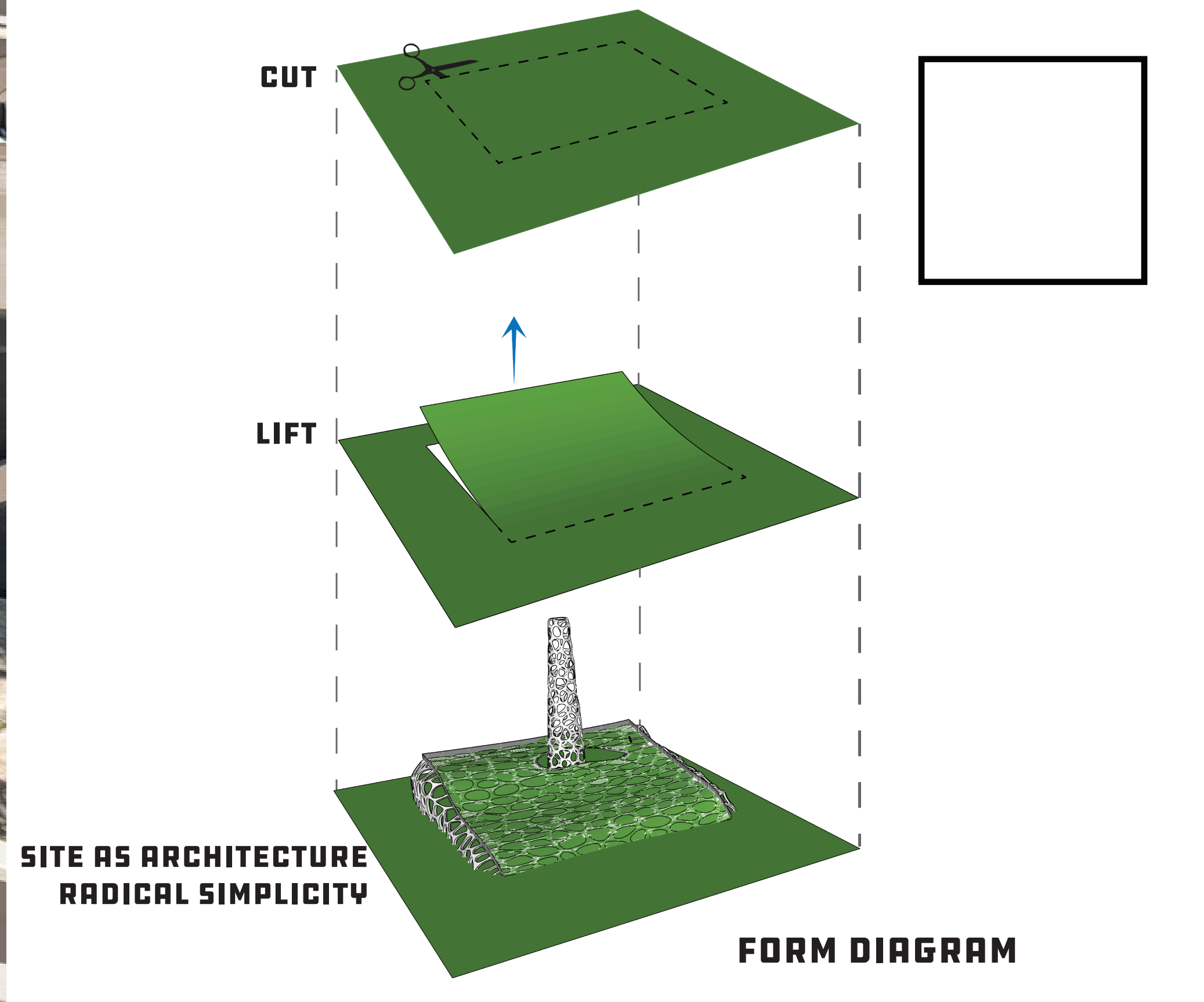
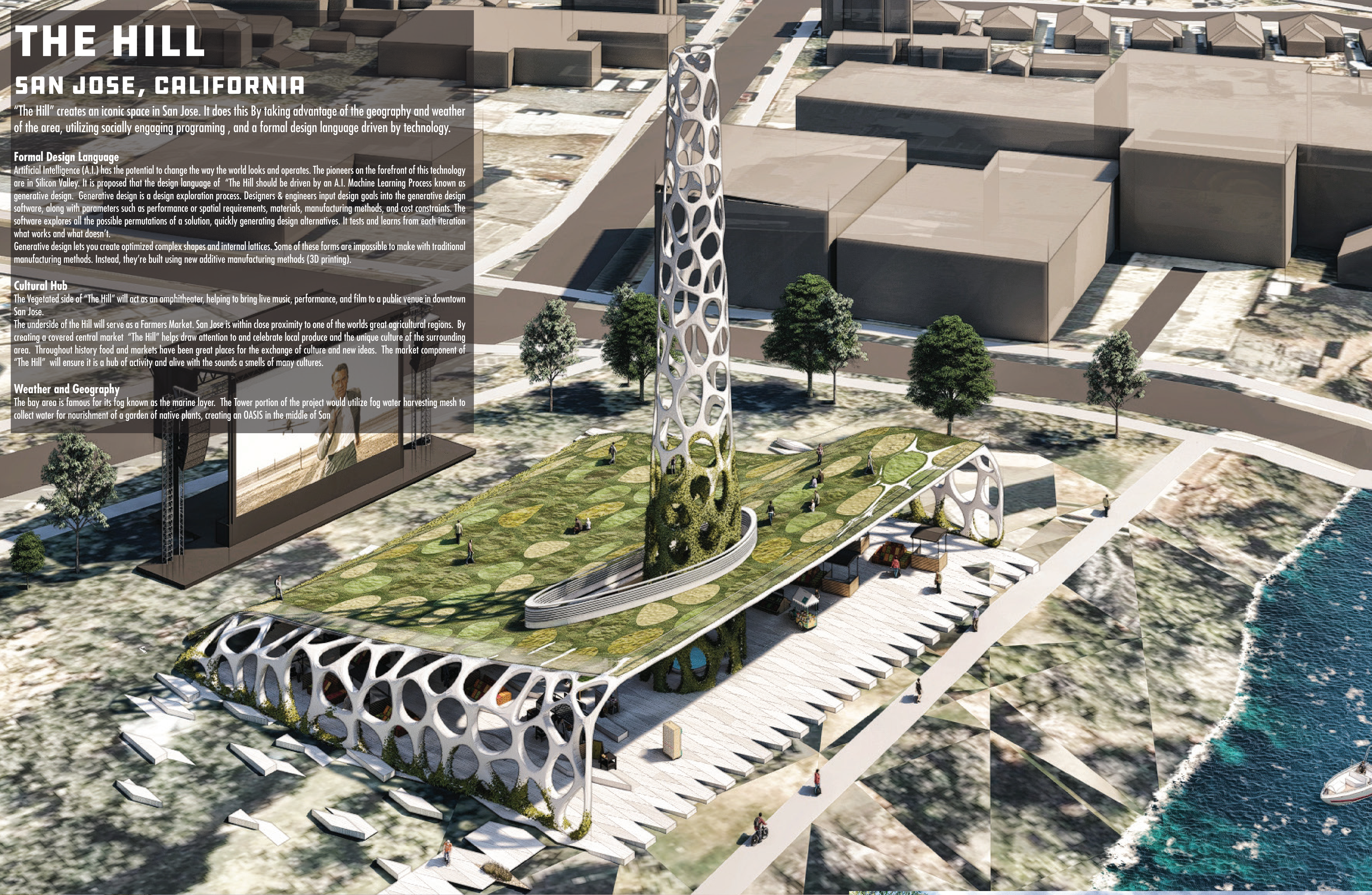

OUTDOOR MOVIE



ROOF PARK



COLLECTION TOWER

